

Sales Code: BEX325A

Description: 600 F/S 2-Door & Classic Basin 1Th

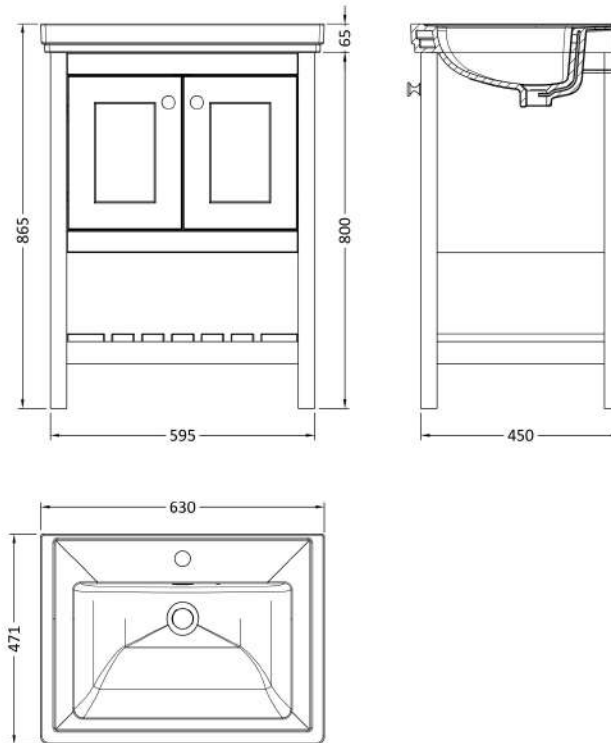

### Packaging Details

Barcode: 5056678422823

Sales Code: BEX325

Description: 600 F/S 2-Door Unit

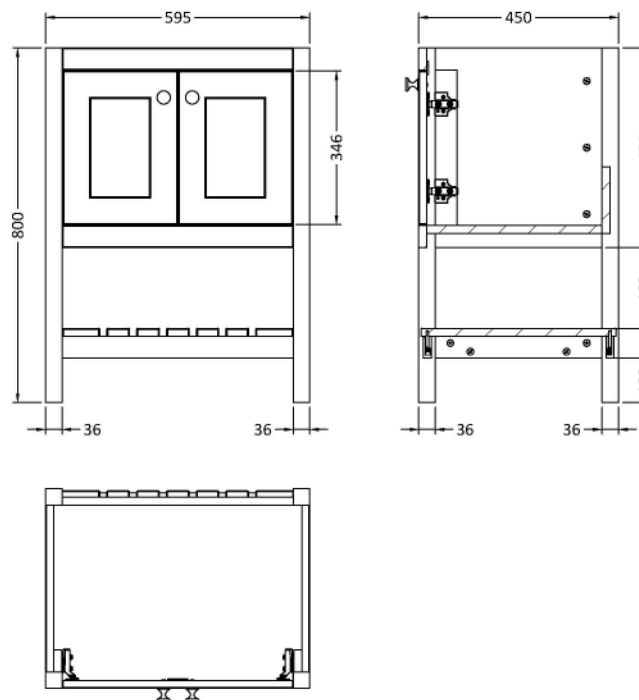

### Product Dimensions

Height (mm):	800
Width (mm):	595
Depth (mm):	450
Nett Weight (kg):	20.5

### Packaging Dimensions

Height (mm):	820
Width (mm):	615
Depth (mm):	470
Gross Weight (kg):	21

### Packaging Data

Box Colour:	Brown Cardboard Box
Box Qty:	0
Label Size:	0 x 0
Label Colour:	White Label
Label Qty:	0

### Outer Box Dimensions (If Applicable)

Height (mm):	
Width (mm):	
Depth (mm):	
Gross Weight (kg):	
Barcode:	5056678422588

### Product Details

Country of Origin:	Ireland
Fitting Instruction:	Yes
CE & UKCA:	
FSC Certified Materials:	Yes
Colour:	Indigo Blue
Construction Method:	Cam & Wood Dowel
Construction Type:	Rigid
Cabinet Finish:	Mdf Vinyl Textured Woodgrain
Fascia Finish:	Mdf Vinyl Textured Woodgrain
Cabinet Thickness (mm):	18
Fascia Thickness (mm):	18
Drawer Included:	No
Drawer Type:	Not Applicable
No of Shelves:	2
Hinge Type:	95 Degree Inset Clip-On S/C
Hinge Included:	Yes
Adjustable Legs:	Not Applicable
Fixings Included:	Not Required
Handle Style:	Traditional
Waste Shroud:	No
Handle Included:	Yes
Handle Type:	Knob

