

TECHNICAL DATA SHEET

P SHAPE | STRAIGHT COMBINATION BASIN UNIT*

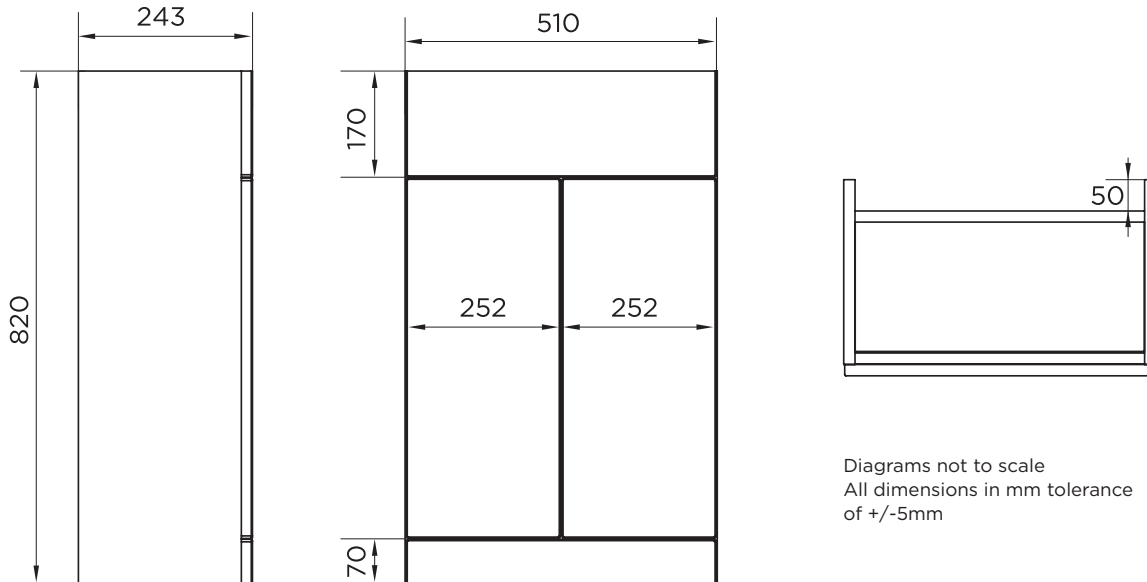

*Requires Basin: 877, 878 or 879

*Requires WC Unit 29136N/

RANGE	COMBINATION
PRODUCT TYPE	COMBINATION VANITY UNIT
CODE	29135N/000 29135N/456 29135N/402 29135N/462 29135N/815
DIMENSIONS (HxWxD)	820 x 510 x 243mm
MATERIAL CARCASS	18mm MFC (Melamine Faced Chipboard)
MATERIAL DOOR	18mm MFC EDGED
PRODUCT WEIGHT	16.15Kg
BASIN REQUIRED	877 (Straight) 878 (Left Hand) or 879 (Right Hand)
ASSEMBLED	PREASSEMBLED
INSTALLATION	FLOOR MOUNTED
GUARANTEE	5 YEARS
MANUFACTURE	MANUFACTURED IN THE UK

**Dimensions are subject to change, customers are advised to measure actual product before commencing installation.

***Fixing point dimensions are for guidance only, the positions of wall fixing must be checked when product is received.