

CUSTOMER DATA SHEET

SALES CODE: GPAF090

DESCRIPTION: 900 Wetroom Screen With Arms And H Feet

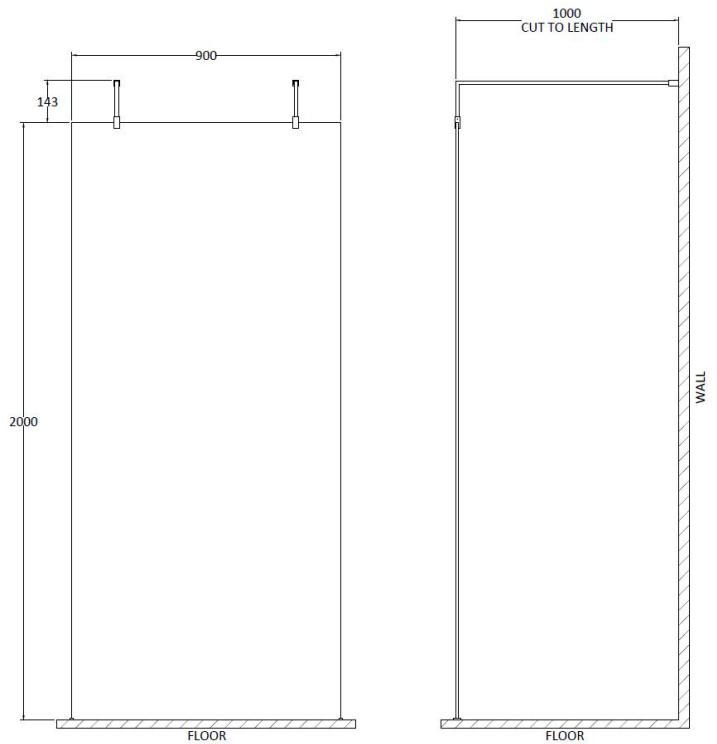

PACKAGING DETAILS

| | |
|-------------|---------------|
| No of Packs | 3 |
| Barcode | 5055275899106 |

CUSTOMER DATA SHEET - SHOWERS

SALES CODE: FIX023

DESCRIPTION: Wetroom Screen Support Arm

| | |
|--|--|
| | |
|--|--|

PRODUCT DIMENSIONS

| Length(mm) | Width (mm) | Height (mm) | Depth (mm) | Nett Wgt Kg |
|------------|------------|-------------|------------|-------------|
| | 150 | 15 | 1000 | 0.7 |

PACKAGING DIMENSIONS

| Length (mm) | Width (mm) | Depth (mm) | Gross Wgt Kg |
|-------------|------------|------------|--------------|
| 1020 | 160 | 35 | 0.7 |

PACKAGING DATA

| | | | |
|------------|---------------------|--------------|-------------|
| Box Colour | White Cardboard Box | | |
| Box Qty | 1 | Label Colour | White Label |
| Label Size | 100 x 50 | Label Qty | 1 |

OUTER BOX DIMENSIONS (If Applicable)

| Length (mm) | Width (mm) | Height (mm) | Depth (mm) | Gross Wgt Kg |
|-------------|---------------|-------------|------------|--------------|
| | | | | |
| Barcode | 5056211800002 | | | |

PRODUCT DETAILS

| | |
|--------------------------|-----------------|
| Coutry of Origin | China |
| Fitting Instruction | No |
| Product Material | Stainless Steel |
| Mount Type | Not Applicable |
| Outlet Elbow Supplied | Not Applicable |
| Easy Clean | Not Applicable |
| Head Included | Not Applicable |
| Handset Included | Not Applicable |
| Body Jets Included | Not Applicable |
| No of Body Jets | Not Applicable |
| Operating Pressure (bar) | |
| Valve/Cartridge Type | Not Applicable |

| Flow Rates (L/min) | 0.1 bar | N/A | 0.5 bar | N/A | 1 bar | N/A | 2 bar | N/A | 3 bar | N/A |
|--------------------|----------------|-----|--------------|-----|-------|-----|-------|-----|-------|-----|
| TMV2 Approved | No | | Approval No. | N/A | | | | | | |
| TMV3 Approved | No | | Approval No. | N/A | | | | | | |
| WRAS Approved | No | | Approval No. | N/A | | | | | | |
| Head Function | Not Applicable | | | | | | | | | |
| Handset Function | Not Applicable | | | | | | | | | |
| Body Jet Info | Not Applicable | | | | | | | | | |
| Pipe Size | Not Applicable | | | | | | | | | |
| Pipe Centres | N/A | | | | | | | | | |
| Colour/Finish | Chrome | | | | | | | | | |
| Hose Included | Not Applicable | | | | | | | | | |

CUSTOMER DATA SHEET - ENCLOSURES

SALES CODE: WRSB900

DESCRIPTION: Wetroom Screen 900 X1950mm

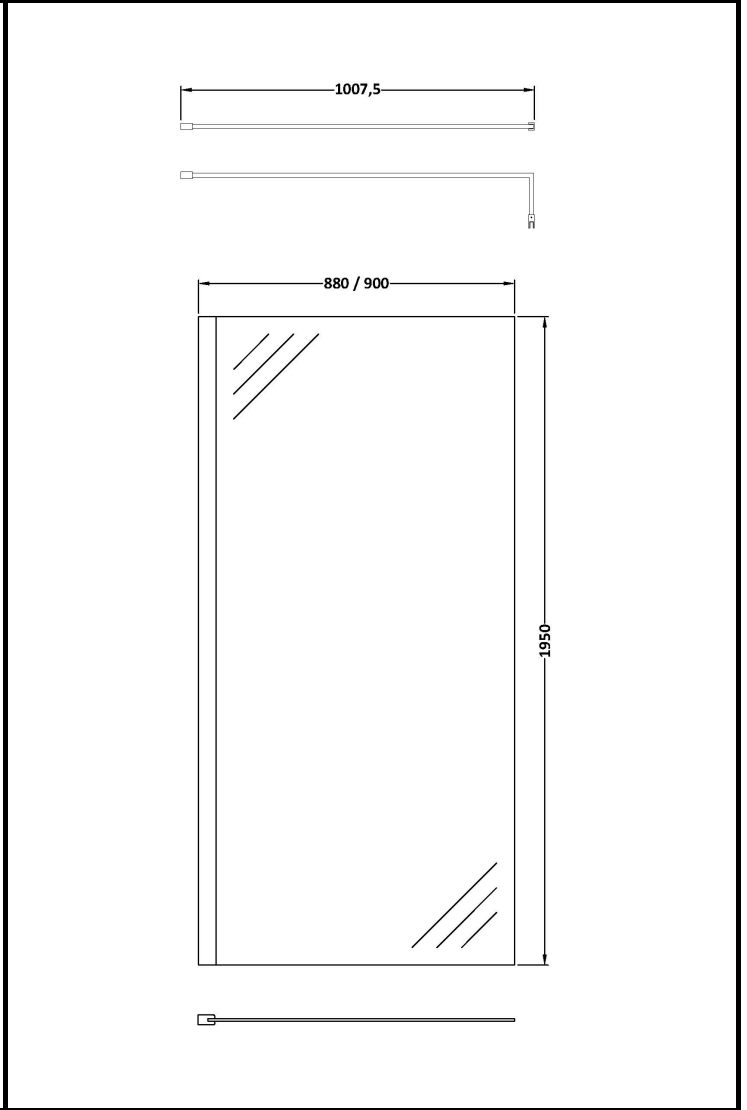

PRODUCT DIMENSIONS

| Height (mm) | Width (mm) | Depth (mm) | Nett Wgt Kg |
|-------------|------------|------------|-------------|
| 1950 | 900 | 14 | 38.24 |

PACKAGING DIMENSIONS

| Height (mm) | Width (mm) | Length (mm) | Gross Wgt Kg |
|-------------|------------|-------------|--------------|
| 65 | 930 | 2010 | 38.24 |

PACKAGING DATA

| | | | |
|------------|-------------------------------|--------------|----------------|
| Box Colour | Brown Cardboard Box - Printed | | |
| Box Qty | 1 | Label Colour | Not Applicable |
| Label Size | 100 x 50 | Label Qty | 0 |

OUTER BOX DIMENSIONS (If Applicable)

| Height (mm) | Width (mm) | Depth (mm) | Length (mm) | Gross Wgt Kg |
|-------------|---------------|------------|-------------|--------------|
| | | | | |
| Barcode | 5055369007455 | | | |

PRODUCT DETAILS

| | | | |
|---------------------|----------------------|----------------------|-----------------|
| Country of Origin | China | CE Approval | No |
| Fitting Instruction | Yes | Profile Finish | Polished Chrome |
| Profile Material | Aluminium | Entry Width (mm) | N/A |
| Adjustments (mm) | 880mm - 900mm | Swing Out Dim (mm) | N/A |
| Swing In Dim (mm) | N/A | Glass Thickness (mm) | 8 |
| Radius (mm) | Not Applicable | Easy Clean | No |
| Easy Fit | No | Handle Material | Not Applicable |
| Handle Style | Not Applicable | Wheel Type | Not Applicable |
| Enclosure Design | Frameless | Extras | None |
| Support Bar Inc' | Support Bar Included | | |

CUSTOMER DATA SHEET - ENCLOSURES

SALES CODE: WRSF003

DESCRIPTION: Wetroom Screen Horseshoe Support Foot

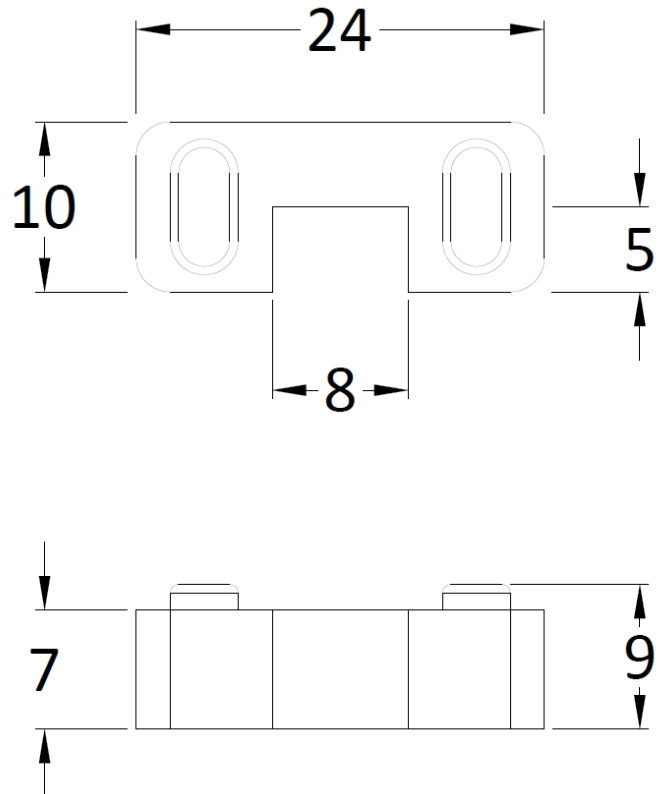

PRODUCT DIMENSIONS

| Height (mm) | Width (mm) | Depth (mm) | Nett Wgt Kg |
|-------------|------------|------------|-------------|
| 45 | 44 | 30 | 0.16 |

PACKAGING DIMENSIONS

| Height (mm) | Width (mm) | Length (mm) | Gross Wgt Kg |
|-------------|------------|-------------|--------------|
| 45 | 30 | 44 | 0.16 |

PACKAGING DATA

| | | | |
|------------|---------------------|--------------|-------------|
| Box Colour | White Cardboard Box | | |
| Box Qty | 1 | Label Colour | White Label |
| Label Size | 100 x 50 | Label Qty | 2 |

OUTER BOX DIMENSIONS (If Applicable)

| Height (mm) | Width (mm) | Depth (mm) | Length (mm) | Gross Wgt Kg |
|-------------|---------------|------------|-------------|--------------|
| 360 | 270 | | | |
| Barcode | 5055275896228 | | | |

PRODUCT DETAILS

| | | | |
|----------------------|----------------|-------------|-----|
| Country of Origin | United Kingdom | CE Approval | N/A |
| Fitting Instruction | Yes | | |
| Profile Material | | | |
| Adjustments (mm) | | | |
| Swing In Dim (mm) | | | |
| Radius (mm) | | | |
| Easy Fit | | | |
| Handle Style | | | |
| Enclosure Design | | | |
| Support Bar Inc' | | | |
| Profile Finish | | | |
| Entry Width (mm) | | | |
| Swing Out Dim (mm) | | | |
| Glass Thickness (mm) | | | |
| Easy Clean | | | |
| Handle Material | | | |
| Wheel Type | | | |
| Extras | | | |