

GENERAL FITTING GUIDE

CONCEALED BATH WASTE

1. Identify all components are present prior to installation.
2. Fit the waste body (6) to the underside of the bath, placing the washer (5) between the bath and the waste body (6). Use a silicone sealant where necessary,
3. Fit the waste plate (3) to the bath using the washer (4) as shown in the diagram below. Fix in place to the waste body (6) using fixing bolt (2). Do not over tighten. Use a silicone sealant where necessary.
4. Fit the overflow elbow (8) to the bath using washer (9)
5. Screw the overflow face (connected to the plug and chain) onto the thread of the overflow elbow (8)
6. Connect the overflow tube (7) to the overflow elbow (8) and waste body (6)
7. Check all joints & connections for leaks.

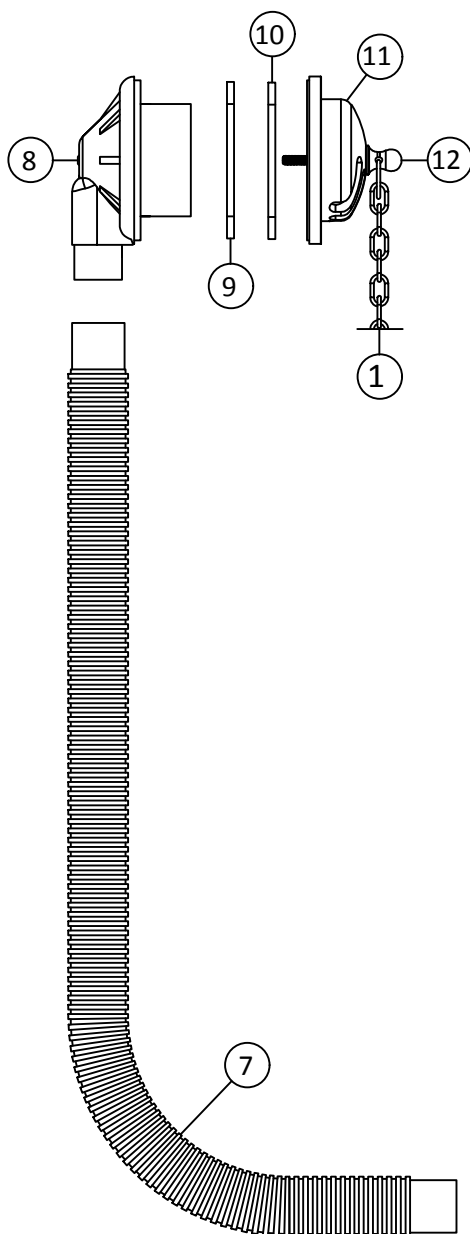

COMPONENTS

1. PLUG & CHAIN ASSEMBLY
2. FIXING BOLT
3. WASTE PLATE
4. FOAM WASHER
5. SEALING WASHER
6. WASTE BODY
7. OVERFLOW TUBE
8. OVERFLOW ELBOW
9. OVERFLOW SEAL WASHER
10. OVERFLOW RUBBER WASHER
11. OVERFLOW FACE
12. FIXING SCREW

