

TECHNICAL DATA SHEET

IKOMA 550 VANITY UNIT*

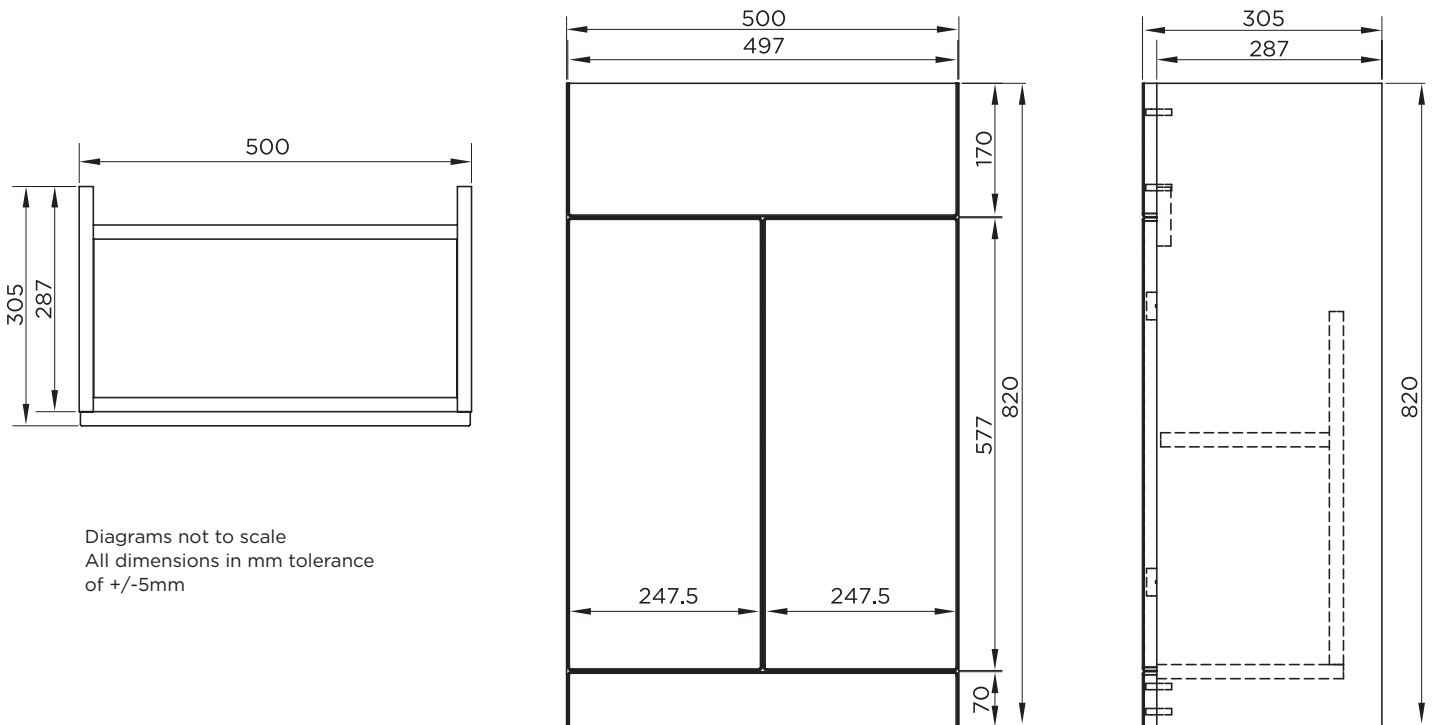

Diagrams not to scale
All dimensions in mm tolerance
of +/-5mm

*Requires Basin: 806

RANGE	IKOMA
PRODUCT TYPE	VANITY UNIT
CODE	29431N/000 29431N/402 29431N/456 29431N/815
DIMENSIONS (HxWxD)	820 x 500 x 305mm
MATERIAL CARCASS	18mm MFC (Melamine Faced Chipboard)
MATERIAL DOOR	18mm MFC EDGED
INTERNAL SHELF	1 (Not Adjustable)
BASIN REQUIRED	806
ASSEMBLED	PREASSEMBLED
INSTALLATION	FLOOR STANDING
PRODUCT WEIGHT	18.1Kg
GUARANTEE	5 YEARS
MANUFACTURE	MANUFACTURED IN THE UK

**Dimensions are subject to change, customers are advised to measure actual product before commencing installation.
***Fixing point dimensions are for guidance only, the positions of wall fixing must be checked when product is received.