

LUNES 2.0 R QUADRANT



QUADRANT SHOWER ENCLOSURE, 2 SLIDING DOORS + 2 FIXED PANELS



Dimensions					Code	Glass				Profile type / Price			
Size	Actual dimensions	Fixed panel	Radius	Access		1	2	11	78	A	B	K	J
	A	F1 F2	R	*		Clear	Aqua	Niva	Lunes 2.0 print.	White	Silver	Chrome	Matt Silver

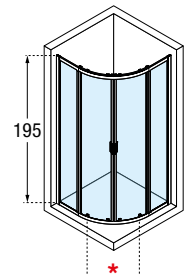

SYMETRICAL VERSION

STANDARD

80	77 ↔ 80	23	◇	55	40	LUNR80-	●						
90	87 ↔ 90	33	◇	55	56	LUNR90-	●						
100	97 ↔ 100	43	◇	55	56	LUNR100-	●						

OFFSET VERSIONS

STANDARD

75x90	72 ↔ 75 x 87 ↔ 90	22	42	45,8	46	LUNR7590-	●						
80x90	77 ↔ 80 x 87 ↔ 90	23	33	55	48	LUNR8090-	●						
80x100	77 ↔ 80 x 97 ↔ 100	23	43	55	48	LUNR80100-	●						
80x120	77 ↔ 80 x 117 ↔ 120	23	63	55	48	LUNR80120-	●						
90x120	87 ↔ 90 x 117 ↔ 120	33	63	55	56	LUNR90120-	●						

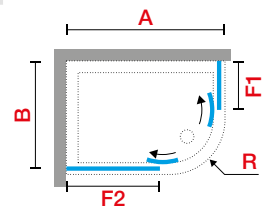
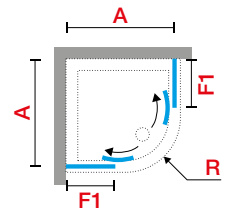

OPTIONAL



● IN STOCK UK
 (Other products) please check availability

Construction of the Code: **Code** + **Glass** + **Profile** = Final product Code

TECHNICAL DATA

GLASS TYPES (European standards UNI EN 14428)



Clear
COD. 1

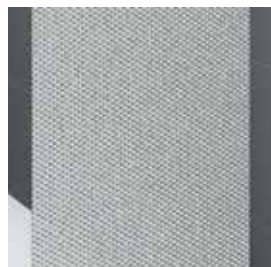

Niva
COD. 11



Aqua
COD. 2

PRINTING

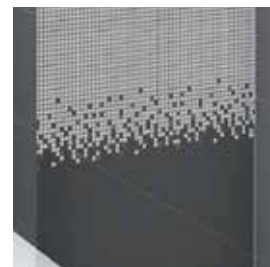

Lunes 2.0
COD. 78

PROFILE COLOURS



White
COD. A



Silver
COD. B



Chrome
COD. K



Matt Silver
COD. J

HANDLES



Chrome or white handle

OVERALL DIMENSIONS FIXING PROFILES

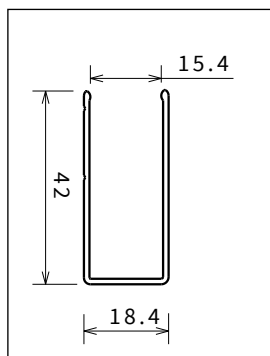

Standard profile
R-2A-2P-2PH-A-AH

Profile type	Code
White	P01BJMOST-A
Silver	P01BJMOST-B
Chrome	P01BJMOST-K
Matt Silver	P01BJMOST-J

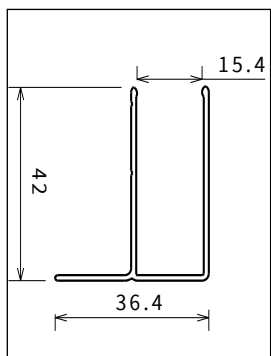

Standard profile
G+FL-3PH-3P-S-B-G

Profile type	Code
White	P0BJGST-A
Silver	P0BJGST-B
Chrome	P0BJGST-K
Matt Silver	P0BJGST-J

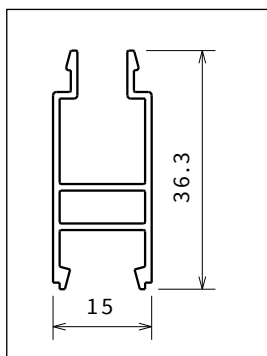

Extension Profile
R-2A-G+FL-3P-3PH-G-B-S-2P-2PH-A-AH

Profile type	Code
White	P05HAAST3-A
Silver	P05HAAST3-B
Chrome	P05HAAST3-K
Matt Silver	P05HAAST3-J

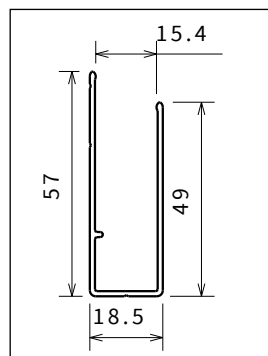

Extension Profile
R-2A-2P-2PH-A-AH

Profile type	Code
White	P05BHST-A
Silver	P05BHST-B
Chrome	P05BHST-K
Matt Silver	P05BHST-J

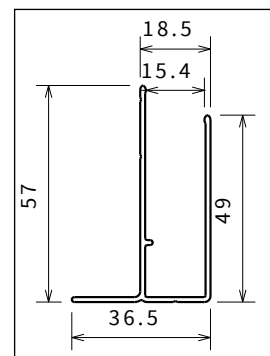

Extension Profile
G+FL-3PH-3P-S-B-G

Profile type	Code
White	P05BHCST-A
Silver	P05BHCST-B
Chrome	P05BHCST-K
Matt Silver	P05BHCST-J

HOW TO TAKE THE MEASUREMENTS

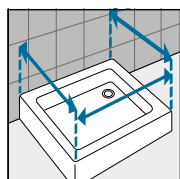
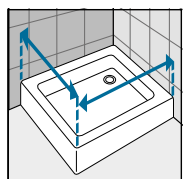

Take the measurements from wall to the external edge of the shower tray. Dimensions must be taken once the walls are finished and tiled, according to the above drawings.

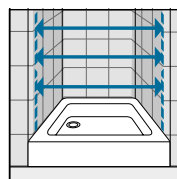

Take the measurements from wall to wall at the bottom, at the top, in the middle and use the smallest. Dimensions must be taken once the walls are finished and tiled, according to the above drawings.

