

TECHNICAL DATA SHEET

L SHAPE COMPACT BASIN UNIT*

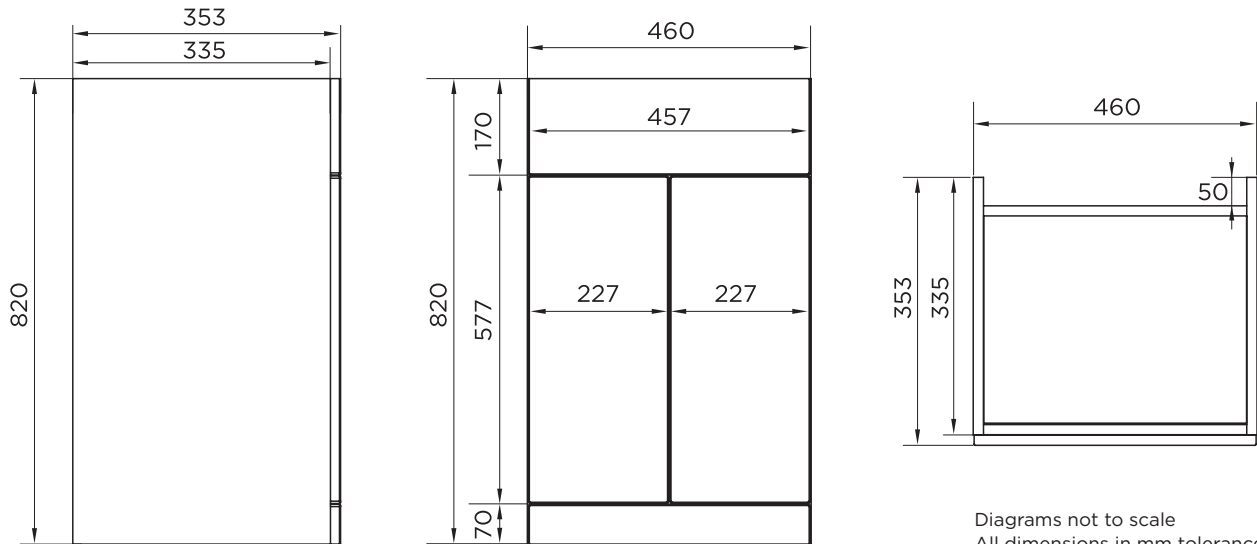

Diagrams not to scale
All dimensions in mm tolerance
of +/-5mm

*Requires Basin: 8592LH or 8592RH

*Requires WC Unit 29284N/000

| | |
|-------------------------|--|
| RANGE | COMPACT L SHAPE |
| PRODUCT TYPE | COMPACT VANITY UNIT |
| CODE | 29283N/000 |
| DIMENSIONS (HxWxD) | 820 x 460 x 353mm |
| MATERIAL CARCASS | 18mm MFC (Melamine Faced Chipboard) |
| MATERIAL DOOR | 18mm MFC EDGED |
| PRODUCT WEIGHT | 18.7Kg |
| BASIN REQUIRED | 8592LH or 8592RH |
| ASSEMBLED | PREASSEMBLED |
| INSTALLATION | FLOOR MOUNTED |
| GUARANTEE | 5 YEARS |
| MANUFACTURE | MANUFACTURED IN THE UK |

**Dimensions are subject to change, customers are advised to measure actual product before commencing installation.

***Fixing point dimensions are for guidance only, the positions of wall fixing must be checked when product is received.