

CUSTOMER DATA SHEET

SALES CODE: GPAF10

DESCRIPTION: 1000 Wetroom Screen With Arms And H Feet

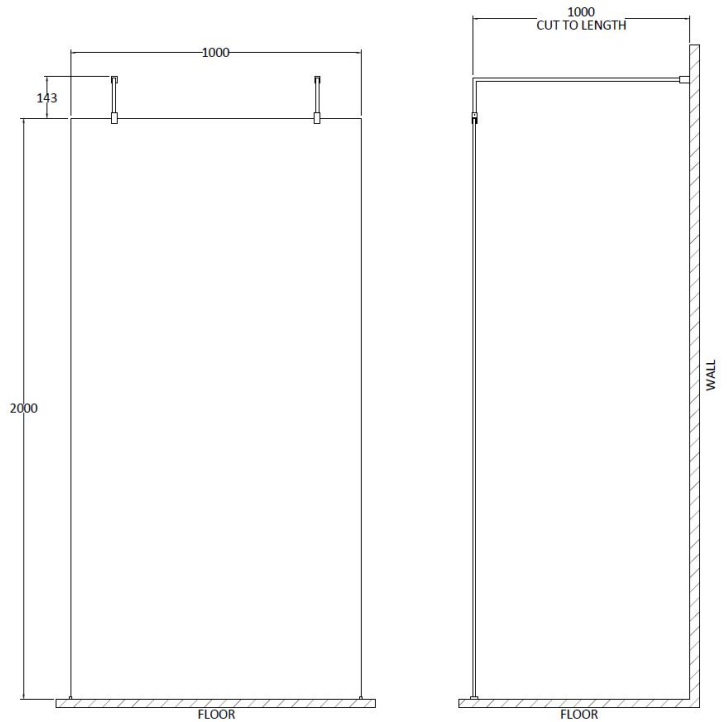

PACKAGING DETAILS

No of Packs	3
Barcode	5055275899113

CUSTOMER DATA SHEET - SHOWERS

SALES CODE: FIX023

DESCRIPTION: Wetroom Screen Support Arm

--	--

PRODUCT DIMENSIONS

Length(mm)	Width (mm)	Height (mm)	Depth (mm)	Nett Wgt Kg
	150	15	1000	0.7

PACKAGING DIMENSIONS

Length (mm)	Width (mm)	Depth (mm)	Gross Wgt Kg
1020	160	35	0.7

PACKAGING DATA

Box Colour	White Cardboard Box		
Box Qty	1	Label Colour	White Label
Label Size	100 x 50	Label Qty	1

OUTER BOX DIMENSIONS (If Applicable)

Length (mm)	Width (mm)	Height (mm)	Depth (mm)	Gross Wgt Kg
Barcode	5056211800002			

PRODUCT DETAILS

Coutry of Origin	China											
Fitting Instruction	No											
Product Material	Stainless Steel											
Mount Type	Not Applicable											
Outlet Elbow Supplied	Not Applicable											
Easy Clean	Not Applicable											
Head Included	Not Applicable											
Handset Included	Not Applicable											
Body Jets Included	Not Applicable											
No of Body Jets	Not Applicable											
Operating Pressure (bar)												
Valve/Cartridge Type	Not Applicable											
Flow Rates (L/min)	0.1 bar	N/A	0.5 bar	N/A	1 bar	N/A	2 bar	N/A	3 bar	N/A		
TMV2 Approved	No			Approval No.		N/A						
TMV3 Approved	No			Approval No.		N/A						
WRAS Approved	No			Approval No.		N/A						
Head Function	Not Applicable											
Handset Function	Not Applicable											
Body Jet Info	Not Applicable											
Pipe Size	Not Applicable											
Pipe Centres	N/A											
Colour/Finish	Chrome											
Hose Included	Not Applicable											

CUSTOMER DATA SHEET - ENCLOSURES

SALES CODE: WRSB1000

DESCRIPTION: Wetroom Screen 1000 X1950mm

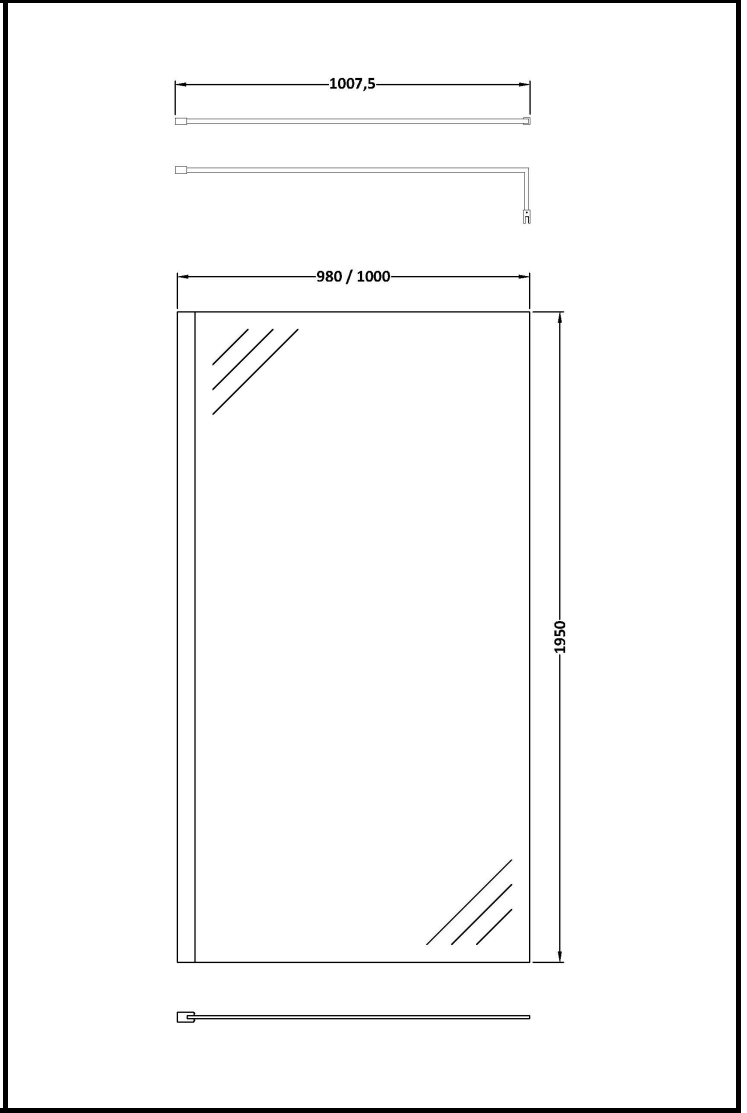

PRODUCT DIMENSIONS

Height (mm)	Width (mm)	Depth (mm)	Nett Wgt Kg
1950	1000	14	42.4

PACKAGING DIMENSIONS

Height (mm)	Width (mm)	Length (mm)	Gross Wgt Kg
65	1085	2009	42.4

PACKAGING DATA

Box Colour	Brown Cardboard Box - Printed		
Box Qty	1	Label Colour	Not Applicable
Label Size	100 x 50	Label Qty	0

OUTER BOX DIMENSIONS (If Applicable)

Height (mm)	Width (mm)	Depth (mm)	Length (mm)	Gross Wgt Kg
Barcode	5055369007462			

PRODUCT DETAILS

Country of Origin	China
Fitting Instruction	Yes
Profile Material	Aluminium
Adjustments (mm)	980mm - 1000mm
Swing In Dim (mm)	N/A
Radius (mm)	Not Applicable
Easy Fit	No
Handle Style	Not Applicable
Enclosure Design	Frameless
Support Bar Inc'	Support Bar Included

CE Approval	No
Profile Finish	Polished Chrome
Entry Width (mm)	N/A
Swing Out Dim (mm)	N/A
Glass Thickness (mm)	8
Easy Clean	No
Handle Material	Not Applicable
Wheel Type	Not Applicable
Extras	None

CUSTOMER DATA SHEET - ENCLOSURES

SALES CODE: WRSF003

DESCRIPTION: Wetroom Screen Horseshoe Support Foot

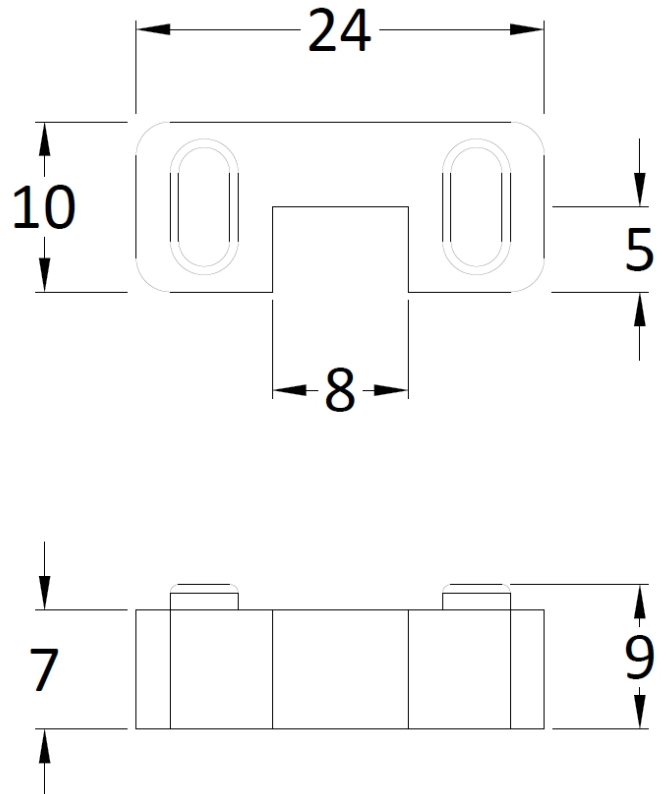

PRODUCT DIMENSIONS

Height (mm)	Width (mm)	Depth (mm)	Nett Wgt Kg
45	44	30	0.16

PACKAGING DIMENSIONS

Height (mm)	Width (mm)	Length (mm)	Gross Wgt Kg
45	30	44	0.16

PACKAGING DATA

Box Colour	White Cardboard Box		
Box Qty	1	Label Colour	White Label
Label Size	100 x 50	Label Qty	2

OUTER BOX DIMENSIONS (If Applicable)

Height (mm)	Width (mm)	Depth (mm)	Length (mm)	Gross Wgt Kg
360	270			
Barcode	5055275896228			

PRODUCT DETAILS

Country of Origin	United Kingdom	CE Approval	N/A
Fitting Instruction	Yes	Profile Finish	
Profile Material		Entry Width (mm)	
Adjustments (mm)		Swing Out Dim (mm)	
Swing In Dim (mm)		Glass Thickness (mm)	
Radius (mm)		Easy Clean	
Easy Fit		Handle Material	
Handle Style		Wheel Type	
Enclosure Design		Extras	
Support Bar Inc'			