

Sales Code: SAR101

Description: 700 W/H 2 Drawer Unit & Basin

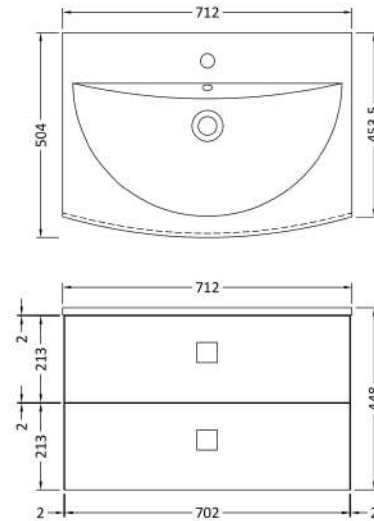
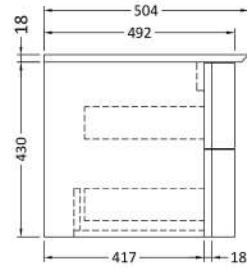

Packaging Details

Barcode: 5056211875031

Sales Code: SAR194

Description: 700 W/H 2 Drawer Unit

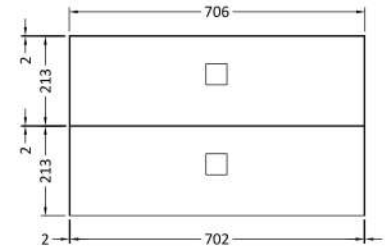
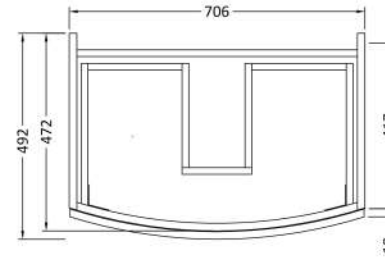
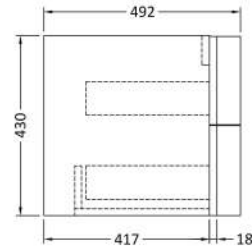

Product Dimensions

| | |
|-------------------|-----|
| Height (mm): | 430 |
| Width (mm): | 710 |
| Depth (mm): | 480 |
| Nett Weight (kg): | 22 |

Packaging Dimensions

| | |
|--------------------|-----|
| Height (mm): | 500 |
| Width (mm): | 700 |
| Depth (mm): | 470 |
| Gross Weight (kg): | 22 |

Packaging Data

| | |
|---------------|---------------------|
| Box Colour: | Brown Cardboard Box |
| Box Qty: | 1 |
| Label Size: | 100 x 50 |
| Label Colour: | White Label |
| Label Qty: | 2 |

Outer Box Dimensions (If Applicable)

| | |
|--------------------|---------------|
| Height (mm): | |
| Width (mm): | |
| Depth (mm): | |
| Gross Weight (kg): | |
| Barcode: | 5056211873877 |

Product Details

| | |
|--------------------------|---------------------------|
| Country of Origin: | Ukraine |
| Fitting Instruction: | No |
| CE & UKCA: | N/A |
| FSC Certified Materials: | Yes |
| Colour: | Moon White |
| Construction Method: | Cam & Wood Dowel |
| Construction Type: | Rigid |
| Cabinet Finish: | MFC Smooth Matt |
| Fascia Finish: | MFC Smooth Matt |
| Cabinet Thickness (mm): | 18 |
| Fascia Thickness (mm): | 18 |
| Drawer Included: | Yes |
| Drawer Type: | 80mm High Metal Softclose |
| No of Shelves: | 0 |
| Hinge Type: | Not Applicable |
| Hinge Included: | Not Applicable |
| Adjustable Legs: | No |
| Fixings Included: | Yes |
| Handle Style: | Modern |
| Waste Shroud: | Yes |
| Handle Included: | Yes |
| Handle Type: | Square |

Sales Code: FMB0073

Description: 712 X 504 Vanity Basin

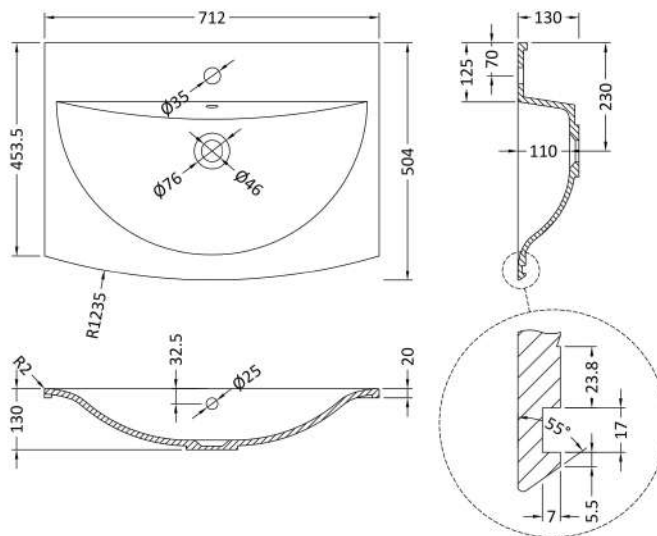

Product Dimensions

| | |
|-------------------|-----|
| Height (mm): | 130 |
| Width (mm): | 712 |
| Depth (mm): | 504 |
| Nett Weight (kg): | 10 |

Packaging Dimensions

| | |
|--------------------|-----|
| Height (mm): | 140 |
| Width (mm): | 722 |
| Depth (mm): | 515 |
| Gross Weight (kg): | 10 |

Packaging Data

| | |
|---------------|-------------------------------|
| Box Colour: | Brown Cardboard Box - Printed |
| Box Qty: | 1 |
| Label Size: | 100 x 50 |
| Label Colour: | White Label |
| Label Qty: | 2 |

Outer Box Dimensions (If Applicable)

| | |
|--------------------|---------------|
| Height (mm): | |
| Width (mm): | |
| Depth (mm): | |
| Gross Weight (kg): | |
| Barcode: | 5055275832462 |

Product Details

| | |
|---------------------------|----------------------------|
| Country of Origin: | Poland |
| Fitting Instruction: | No |
| Certification: CE & UKCA: | N/A WRAS: N/A WRAS No: N/A |
| Product Material: | Polymarble |
| Fixing Supplied: | No |

Pans/Bidets: Trap Style: Not Applicable Includes Seat: Not Applicable

Seats: Seat Type: Not Applicable Material: Not Applicable
Function: Not Applicable Hinge Type: Not Applicable
Hinge Material: Not Applicable

Cisterns: Operating Type: Not Applicable Fittings: Not Applicable
Lever Type: Not Applicable

Basins: Tap Hole: One Taphole Chain Stay Hole: No
Template: Not Required Waste Type Req: Slotted
Overflow Inc: Yes Overflow Cover: Yes
Inner Bowl Depth (mm): 110mm