

CUSTOMER DATA SHEET

SALES CODE: GPAF12

DESCRIPTION: 1200 Wetroom Screen With Arms And H Feet

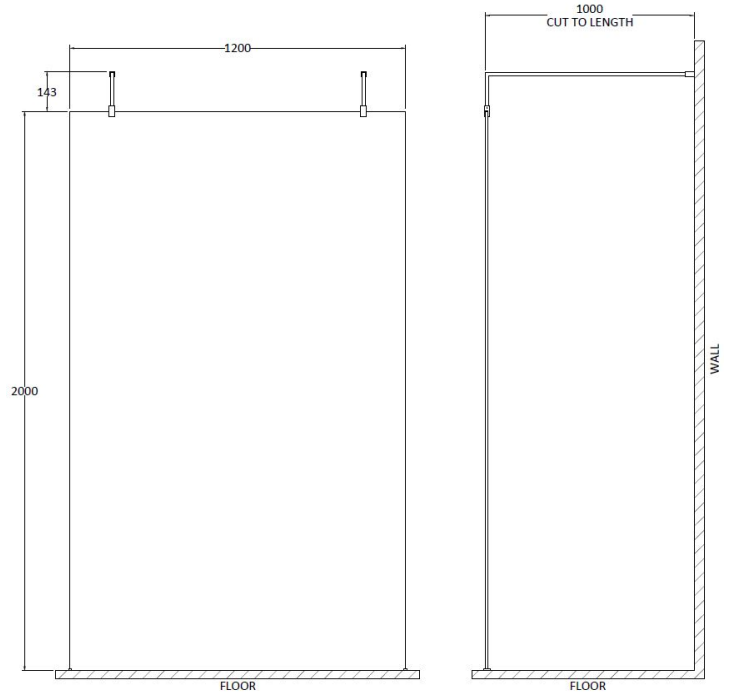

PACKAGING DETAILS

No of Packs	3
Barcode	5055275899120

CUSTOMER DATA SHEET - SHOWERS

SALES CODE: FIX023

DESCRIPTION: Wetroom Screen Support Arm

--	--

PRODUCT DIMENSIONS

Length(mm)	Width (mm)	Height (mm)	Depth (mm)	Nett Wgt Kg
	150	15	1000	0.7

PACKAGING DIMENSIONS

Length (mm)	Width (mm)	Depth (mm)	Gross Wgt Kg
1020	160	35	0.7

PACKAGING DATA

Box Colour	White Cardboard Box		
Box Qty	1	Label Colour	White Label
Label Size	100 x 50	Label Qty	1

OUTER BOX DIMENSIONS (If Applicable)

Length (mm)	Width (mm)	Height (mm)	Depth (mm)	Gross Wgt Kg
Barcode	5056211800002			

PRODUCT DETAILS

Coutry of Origin	China										
Fitting Instruction	No										
Product Material	Stainless Steel										
Mount Type	Not Applicable										
Outlet Elbow Supplied	Not Applicable										
Easy Clean	Not Applicable										
Head Included	Not Applicable										
Handset Included	Not Applicable										
Body Jets Included	Not Applicable										
No of Body Jets	Not Applicable										
Operating Pressure (bar)											
Valve/Cartridge Type	Not Applicable										
Flow Rates (L/min)	0.1 bar	N/A	0.5 bar	N/A	1 bar	N/A	2 bar	N/A	3 bar	N/A	
TMV2 Approved	No		Approval No.		N/A						
TMV3 Approved	No		Approval No.		N/A						
WRAS Approved	No		Approval No.		N/A						
Head Function	Not Applicable										
Handset Function	Not Applicable										
Body Jet Info	Not Applicable										
Pipe Size	Not Applicable										
Pipe Centres	N/A										
Colour/Finish	Chrome										
Hose Included	Not Applicable										

CUSTOMER DATA SHEET - ENCLOSURES

SALES CODE: WRSB1200

DESCRIPTION: Wetroom Screen 1200 X1950mm

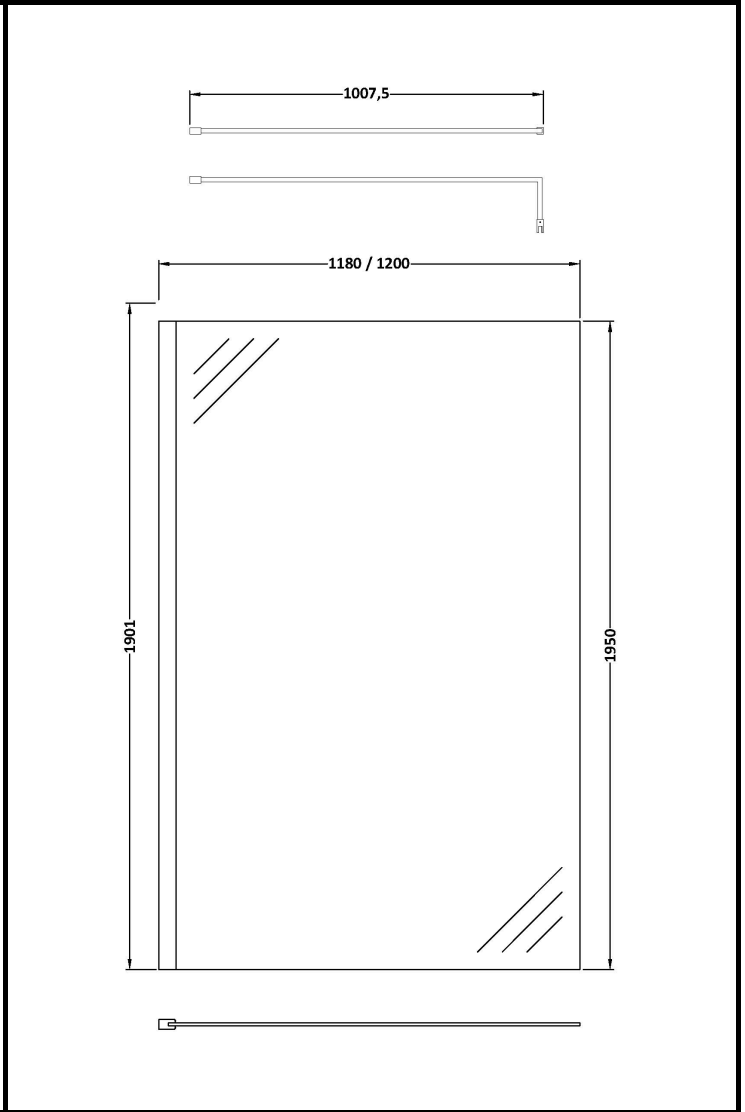

PRODUCT DIMENSIONS

Height (mm)	Width (mm)	Depth (mm)	Nett Wgt Kg
1950	1200	14	50.4

PACKAGING DIMENSIONS

Height (mm)	Width (mm)	Length (mm)	Gross Wgt Kg
65	1250	2009	50.4

PACKAGING DATA

Box Colour	Brown Cardboard Box - Printed		
Box Qty	1	Label Colour	Not Applicable
Label Size	100 x 50	Label Qty	0

OUTER BOX DIMENSIONS (If Applicable)

Height (mm)	Width (mm)	Depth (mm)	Length (mm)	Gross Wgt Kg
Barcode	5055369007479			

PRODUCT DETAILS

Country of Origin	China	CE Approval	No
Fitting Instruction	Yes	Profile Finish	Polished Chrome
Profile Material	Aluminium	Entry Width (mm)	N/A
Adjustments (mm)	1180mm - 1200mm	Swing Out Dim (mm)	N/A
Swing In Dim (mm)	N/A	Glass Thickness (mm)	8
Radius (mm)	Not Applicable	Easy Clean	No
Easy Fit	No	Handle Material	Not Applicable
Handle Style	Not Applicable	Wheel Type	Not Applicable
Enclosure Design	Frameless	Extras	None
Support Bar Inc'	Support Bar Included		

CUSTOMER DATA SHEET - ENCLOSURES

SALES CODE: WRSF003

DESCRIPTION: Wetroom Screen Horseshoe Support Foot

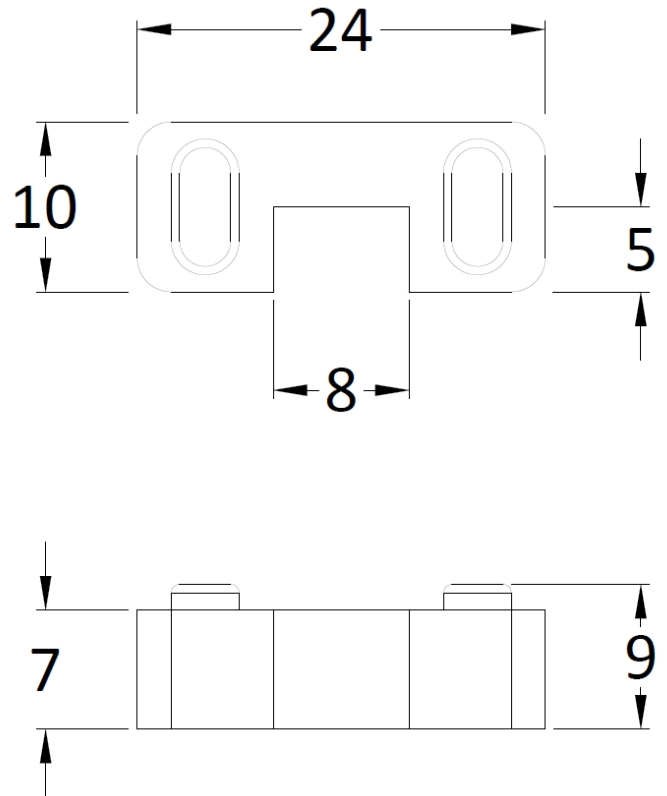

PRODUCT DIMENSIONS

Height (mm)	Width (mm)	Depth (mm)	Nett Wgt Kg
45	44	30	0.16

PACKAGING DIMENSIONS

Height (mm)	Width (mm)	Length (mm)	Gross Wgt Kg
45	30	44	0.16

PACKAGING DATA

Box Colour	White Cardboard Box		
Box Qty	1	Label Colour	White Label
Label Size	100 x 50	Label Qty	2

OUTER BOX DIMENSIONS (If Applicable)

Height (mm)	Width (mm)	Depth (mm)	Length (mm)	Gross Wgt Kg
360	270			
Barcode	5055275896228			

PRODUCT DETAILS

Country of Origin	United Kingdom	CE Approval	N/A
Fitting Instruction	Yes	Profile Finish	
Profile Material		Entry Width (mm)	
Adjustments (mm)		Swing Out Dim (mm)	
Swing In Dim (mm)		Glass Thickness (mm)	
Radius (mm)		Easy Clean	
Easy Fit		Handle Material	
Handle Style		Wheel Type	
Enclosure Design		Extras	
Support Bar Inc'			