

## CUSTOMER DATA SHEET

SALES CODE: GPAF080

DESCRIPTION: 800 Wetroom Screen With Arms And H Feet

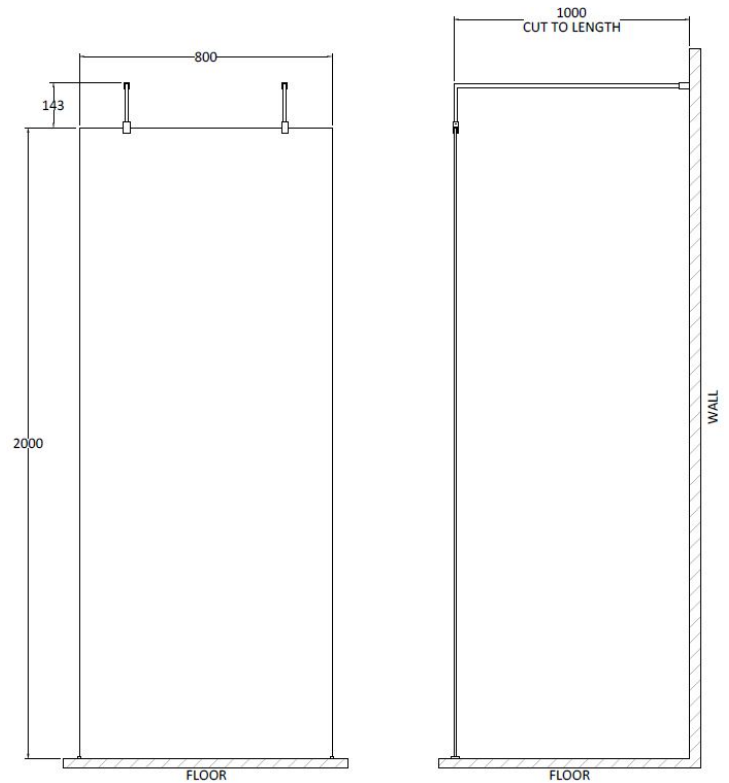

### PACKAGING DETAILS

No of Packs	3
Barcode	5055275899090

## CUSTOMER DATA SHEET - SHOWERS

SALES CODE: FIX023

DESCRIPTION: Wetroom Screen Support Arm

--	--

### PRODUCT DIMENSIONS

Length(mm)	Width (mm)	Height (mm)	Depth (mm)	Nett Wgt Kg
	150	15	1000	0.7

### PACKAGING DIMENSIONS

Length (mm)	Width (mm)	Depth (mm)	Gross Wgt Kg
1020	160	35	0.7

### PACKAGING DATA

Box Colour	White Cardboard Box		
Box Qty	1	Label Colour	White Label
Label Size	100 x 50	Label Qty	1

### OUTER BOX DIMENSIONS (If Applicable)

Length (mm)	Width (mm)	Height (mm)	Depth (mm)	Gross Wgt Kg
Barcode	5056211800002			

### PRODUCT DETAILS

Coutry of Origin	China
Fitting Instruction	No
Product Material	Stainless Steel
Mount Type	Not Applicable
Outlet Elbow Supplied	Not Applicable
Easy Clean	Not Applicable
Head Included	Not Applicable
Handset Included	Not Applicable
Body Jets Included	Not Applicable
No of Body Jets	Not Applicable
Operating Pressure (bar)	
Valve/Cartridge Type	Not Applicable

Flow Rates (L/min)	0.1 bar	N/A	0.5 bar	N/A	1 bar	N/A	2 bar	N/A	3 bar	N/A
TMV2 Approved	No		Approval No.	N/A						
TMV3 Approved	No		Approval No.	N/A						
WRAS Approved	No		Approval No.	N/A						
Head Function	Not Applicable									
Handset Function	Not Applicable									
Body Jet Info	Not Applicable									
Pipe Size	Not Applicable									
Pipe Centres	N/A									
Colour/Finish	Chrome									
Hose Included	Not Applicable									

## CUSTOMER DATA SHEET - ENCLOSURES

SALES CODE: WRSB800

DESCRIPTION: Wetroom Screen 800 X1950mm

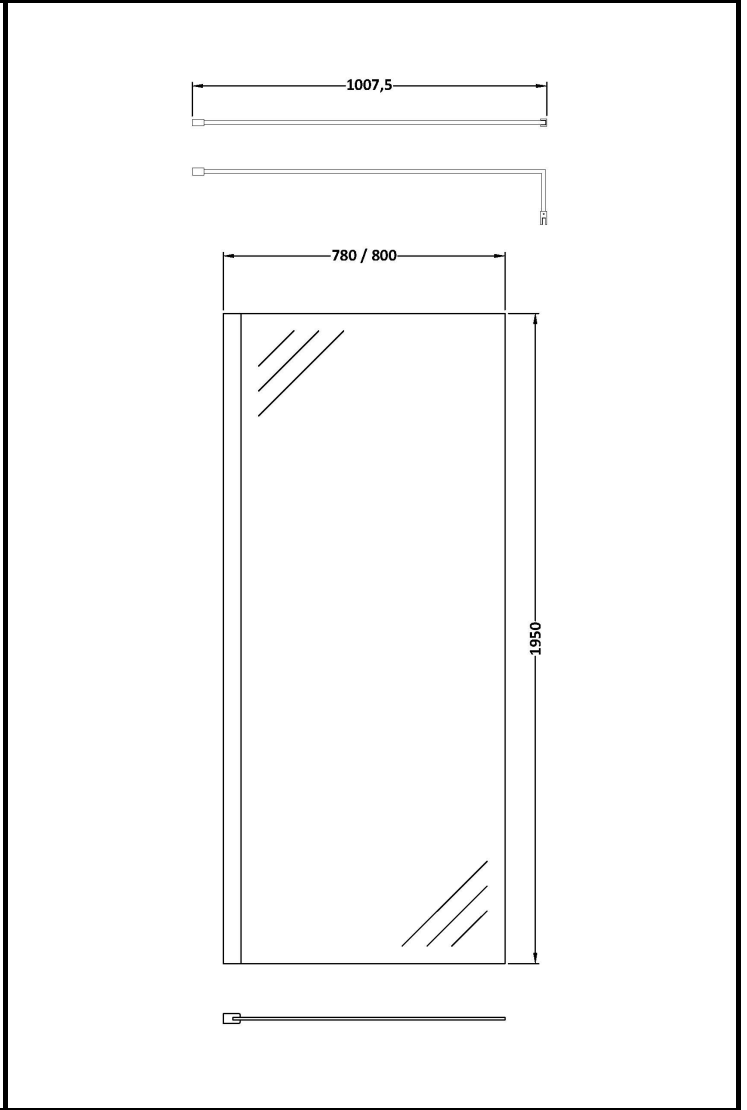

### PRODUCT DIMENSIONS

Height (mm)	Width (mm)	Depth (mm)	Nett Wgt Kg
1950	800	14	34.36

### PACKAGING DIMENSIONS

Height (mm)	Width (mm)	Length (mm)	Gross Wgt Kg
65	830	2010	34.36

### PACKAGING DATA

Box Colour	Brown Cardboard Box - Printed		
Box Qty	1	Label Colour	Not Applicable
Label Size	100 x 50	Label Qty	0

### OUTER BOX DIMENSIONS (If Applicable)

Height (mm)	Width (mm)	Depth (mm)	Length (mm)	Gross Wgt Kg
Barcode	5055369007448			

### PRODUCT DETAILS

Country of Origin	China
Fitting Instruction	Yes
Profile Material	Aluminium
Adjustments (mm)	780mm - 800mm
Swing In Dim (mm)	N/A
Radius (mm)	Not Applicable
Easy Fit	No
Handle Style	Not Applicable
Enclosure Design	Frameless
Support Bar Inc'	Support Bar Included

CE Approval	No
Profile Finish	Polished Chrome
Entry Width (mm)	N/A
Swing Out Dim (mm)	N/A
Glass Thickness (mm)	8
Easy Clean	No
Handle Material	Not Applicable
Wheel Type	Not Applicable
Extras	None

## CUSTOMER DATA SHEET - ENCLOSURES

SALES CODE: WRSF003

DESCRIPTION: Wetroom Screen Horseshoe Support Foot

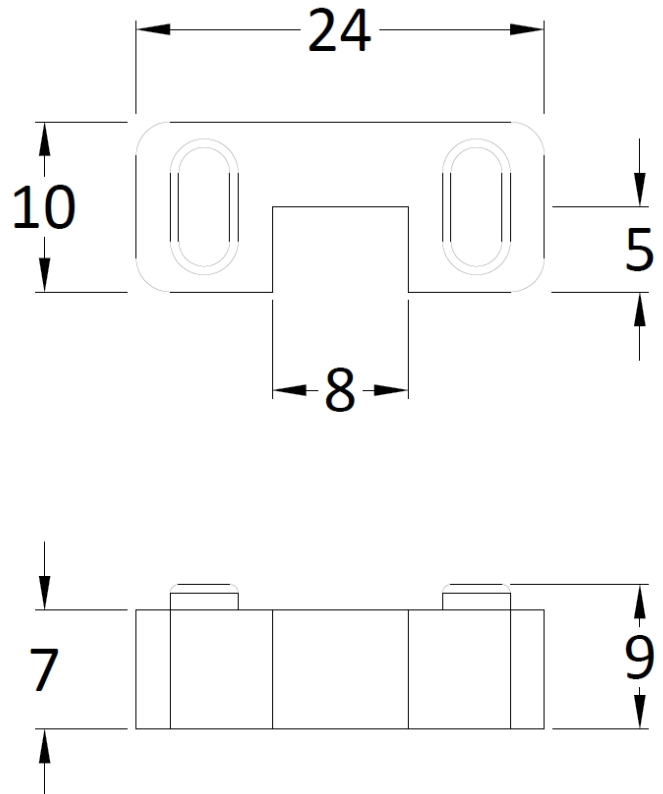

### PRODUCT DIMENSIONS

Height (mm)	Width (mm)	Depth (mm)	Nett Wgt Kg
45	44	30	0.16

### PACKAGING DIMENSIONS

Height (mm)	Width (mm)	Length (mm)	Gross Wgt Kg
45	30	44	0.16

### PACKAGING DATA

Box Colour	White Cardboard Box		
Box Qty	1	Label Colour	White Label
Label Size	100 x 50	Label Qty	2

### OUTER BOX DIMENSIONS (If Applicable)

Height (mm)	Width (mm)	Depth (mm)	Length (mm)	Gross Wgt Kg
360	270			
Barcode	5055275896228			

### PRODUCT DETAILS

Country of Origin	United Kingdom	CE Approval	N/A
Fitting Instruction	Yes	Profile Finish	
Profile Material		Entry Width (mm)	
Adjustments (mm)		Swing Out Dim (mm)	
Swing In Dim (mm)		Glass Thickness (mm)	
Radius (mm)		Easy Clean	
Easy Fit		Handle Material	
Handle Style		Wheel Type	
Enclosure Design		Extras	
Support Bar Inc'			