

# BATH ASSEMBLY INSTRUCTION

PUSH BUTTON  
WASTE

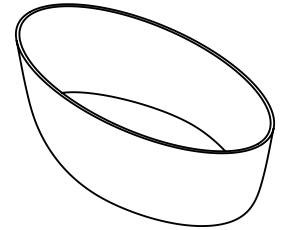
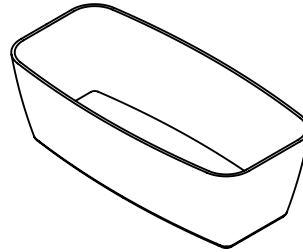
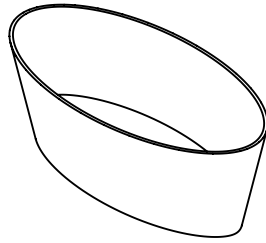
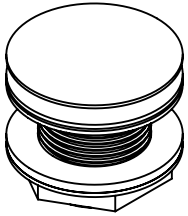

## CAREFULLY READ THROUGH ALL INSTRUCTIONS

- Each Solid Surface Bath will come packed in a protective case with internal packaging.
- The bath has been inspected and photographed before leaving our dispatch.
- The product **MUST** be installed by a qualified and competent plumber.
- Carefully remove the bath from the box, taking care not to drag, drop or scratch any part of the exposed surfaces.



- Always protect the surface of your bath when installing and handling. Cardboard or an old blanket should provide adequate protection on the floor.
- Avoid getting cement, grit, sand or masonry products on the surface.
- Protect and cover the bath during installation as other tradesmen might damage the bath if precautions aren't taken.
- Never use Brown Tape or Gaffer Tape directly on to the surface. If the bath has to be repacked remember to avoid taping directly on to the surface of the bath.
- Do not remove the protective packaging on the bath until installation is complete.
- **Important** - the temperature of water entering the bath must not exceed 59 degrees. Higher water temperatures could cause "Heat Shock" and cracking in the surface of the bath.

### Push Button Waste

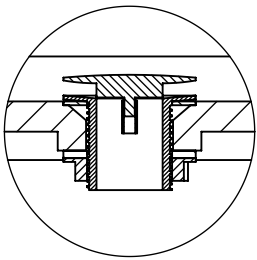

Insert the 'Push Button Waste' through the aperture and seal it in place using a silicone sealant. **DO NOT OVERTIGHTEN** the Backnut as this may cause the bath to crack.

**DO NOT** seal with putty.

### Bath Fixing

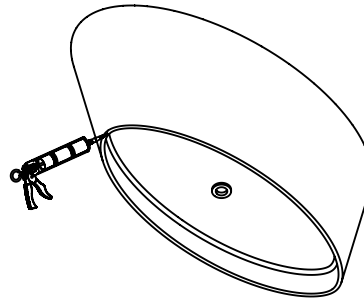

Attach waste fittings and fix your bath using white/clear bath sealant which must be applied to the bottom face of the bath. Clean off excess and be careful not to over-silicone.

Ensure the flexible waste connector kit is securely connected to the bath and waste outflow system before positioning the bath. **(NOT SUPPLIED)**.

### Cutting An Access Hole

We recommend that the waste outlet should always go below the floor level, wherever possible; however, if an overflow hole or an outlet hole for a waste pipe is to be installed above the floor, please follow these instructions.

**Any modification to the bath is at the owner's risk and will void any warranty.**

#### Overflow Hole

Place the bath on it's side on a soft sheet to prevent scratches. You will need a 50mm hole saw suitable for drilling hardwood with a pilot drill in the centre. Mark where you require the centre of the overflow hole, on the outside of the bath. (This will depend on the depth of water you require). It will normally be between 70-90mm from the top of the bath. A piece of masking tape placed over this area helps prevent the drill bit from slipping. Start to drill into the bath with the hole saw until the pilot drill comes through the other side and the saw is about halfway through the thickness of the bath.

Now start drilling from the inside of the bath using the pilot hole you can now see. When drilling, be patient and go slow so that the heat build-up when drilling doesn't "burn" the material. The application of water on to the area whilst drilling will also help prevent this. Once the hole is complete, sand the inside of the hole until it is smooth.

#### Waste Outlet Hole

**Important** - Do not cut a square or mousehole into the side of the bath near the floor. This will invalidate your guarantee and may cause the bath to crack over time. Follow the same directions as for drilling the overflow hole, however the bottom of the waste hole should be a **minimum** of 20mm from the bottom edge of the bath. Remember to sand the hole when completed, and use water on the area to reduce the heat of the hole saw when drilling.