

SWIVEL PANEL



IMPORTANT

Thank you for choosing Merlyn. Please familiarise yourself with the fitting instructions before commencing fitting.

DO NOT attempt to install the product unless you can tick ALL 4 boxes as satisfactory.

- 1. Check that you have the tools required.
- 2. Check the installation site is compatible with size of door supplied

- 3. Check all the enclosure components.
- 4. Check the installation kit is complete

Any parts missing or damaged must be reported to your supplier within 5 days of purchase. Inspect shower enclosure before fitting as no claims will be acceptable after product has been installed.

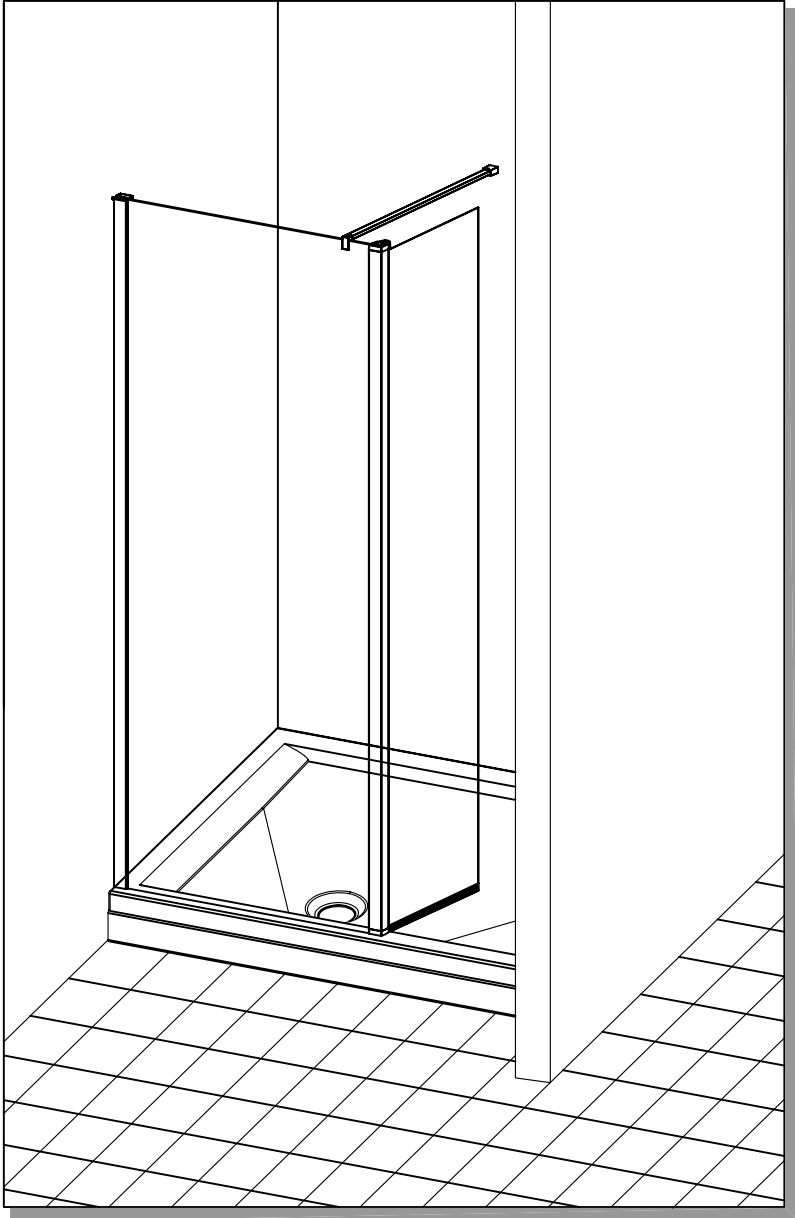

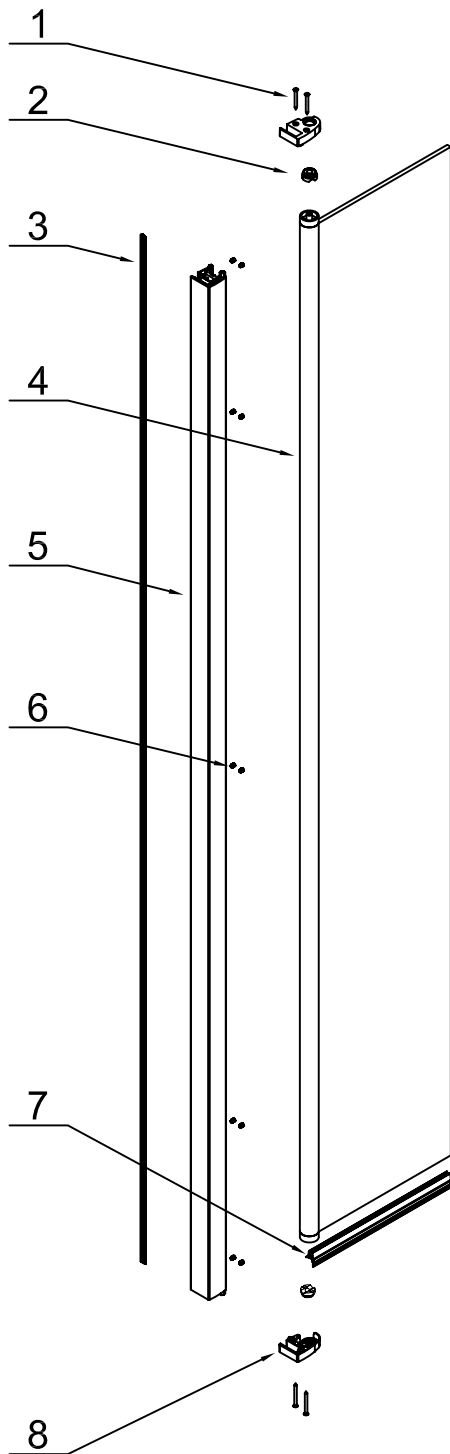

No.	Description	QTY	Part No.
1	Countersunk self-tapping screw ST4*45	4	
2	Rising butt nylon	2	
3	Wedge seal	1	
4	Moving panel	1	
5	Pivot base profile	1	
6	Screw 6*12	10	
7	Water bottom seal	1	
8	Bracket(1 left, 1 right)	2	

Fixing Kit components



3ALKEY
x 1

Tools required

- #2 Philips Head screw driver

