

# PRODUCT DATA SHEET

*Burlington*<sup>®</sup>



## PRODUCT CODE

GUSHOWERPACKSQ3G

## RANGE

Guild

## DESCRIPTION

Guild Square Thermostatic Two Outlet Concealed Divertor Shower Valve , Fixed Shower Arm & Head, Holder &

|                       |              |
|-----------------------|--------------|
| CATEGORY              | Brassware    |
| WARRANTY DETAILS      | 15 Years     |
| COLOUR                | Gold         |
| FINISH APPLICATION    | PVD          |
| PRIMARY MATERIAL      | Brass        |
| INSTALL TYPE          | Wall Mounted |
| PRODUCT NET WEIGHT KG | 5.05         |
| STANDARDS             | EN1111       |

|                                    |                                       |
|------------------------------------|---------------------------------------|
| MINIMUM PRESSURE (BAR)             | 0.5                                   |
| MAX WORKING PRESSURE (BAR)         | 5                                     |
| NUMBER OF OUTLETS                  | 2                                     |
| NUMBER OF FUNCTIONS                | 2                                     |
| HEADWORK                           | Thermostatic cartridge, 40mm Diverter |
| SWIVEL SPOUT                       | No                                    |
| INLET CONNECTIONS THREAD           | G3/4"                                 |
| OUTLET CONNECTIONS THREAD          | G1/2"                                 |
| WASTE INCLUDED                     | No                                    |
| ANTI-SCALD                         | No                                    |
| ENERGY SAVING                      | No                                    |
| SHOWER HOSE & HANDSET ARE INCLUDED | Yes                                   |

| PRESSURE (BAR)      | 0.2 | 0.5   | 1     | 2     | 3     | 4     | 5    |
|---------------------|-----|-------|-------|-------|-------|-------|------|
| PRIMARY FLOWRATE    |     | 8.2   | 11.6  | 14.16 | 17.08 | 19.48 | 21.8 |
| HANDSET FLOWRATE    |     | 16.65 | 23.56 | 29.68 | 37.2  | 43.92 | 46.7 |
| MESSAGE FLOW RATE   |     |       |       |       |       |       |      |
| AIR FLOW RATE       |     |       |       |       |       |       |      |
| WIRE FLOW RATE      |     |       |       |       |       |       |      |
| WATERFALL FLOW RATE |     |       |       |       |       |       |      |
| MIST FLOW RATE      |     |       |       |       |       |       |      |
| HANDSPRAY FLOW RATE |     |       |       |       |       |       |      |

## TECHNICAL DIMENSIONS

Dimensions in mm unless otherwise specified.

Tolerances (per material type) apply.

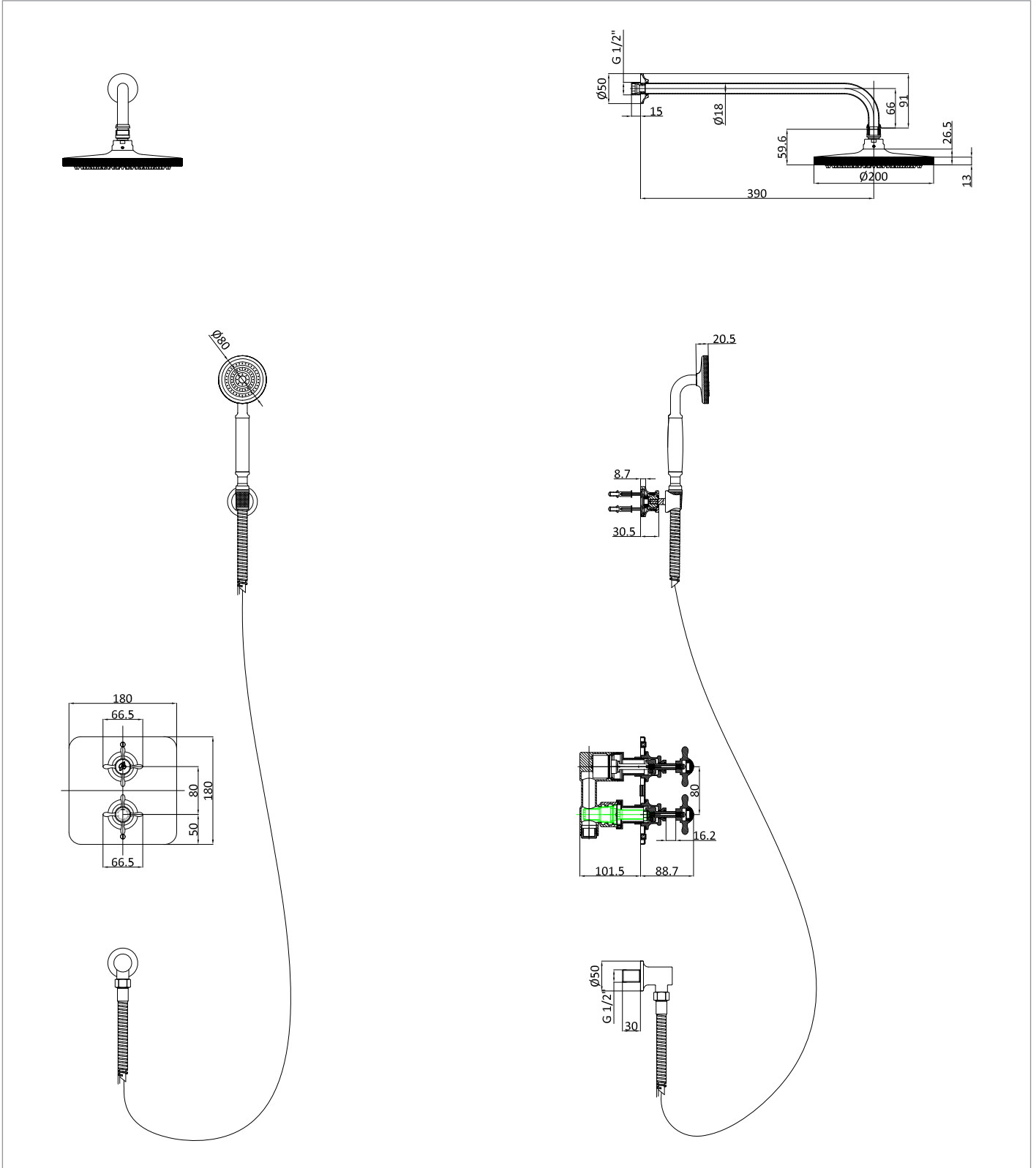

## SPARES LIST

Only the parts labelled are available as spares.

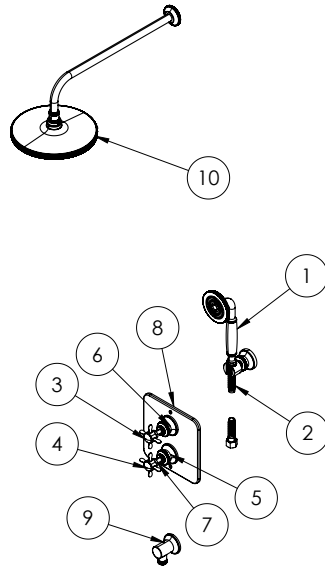

| NUMBER | PART CODE  | DESCRIPTION   |
|--------|------------|---|
| 1      | SP1854BNKL | Guild handset in Brushed Nickel   |
|        | SP1854GOLD | Guild handset in Gold   |
|        | SP1854CHR  | Guild handset in Chrome   |
| 2      | SP1855BNKL | Guild shower hose in Brushed Nickel                                       |
|        | SP1855GOLD | Guild shower hose in Gold   |
|        | SP1855CHR  | Guild shower hose in Chrome   |
| 3      | SP1857     | Guild B logo ceramic indice with O ring for shower products               |
| 4      | SP1858     | Guild Hot Cold ceramic indice with O ring for shower products             |
| 5      | SP1859BNKL | Guild Diverter handle assembly for shower products in Brushed Nickel      |
|        | SP1859GOLD | Guild Diverter handle assembly for shower products in Gold                |
|        | SP1859CHR  | Guild Diverter handle assembly for shower products in Chrome              |
| 6      | SP1860BNKL | Guild Thermo handle assembly for shower products in Brushed Nickel        |
|        | SP1860GOLD | Guild Thermo handle assembly for shower products in Gold                  |
|        | SP1860CHR  | Guild Thermo handle assembly for shower products in Chrome                |
| 7      | SP1861BNKL | Guild Handle cartridge cap assembly for shower products in Brushed Nickel |
|        | SP1861GOLD | Guild Handle cartridge cap assembly for shower products in Gold           |
|        | SP1861CHR  | Guild Handle cartridge cap assembly for shower products in Chrome         |
| 8      | SP1862BNKL | Guild Square back plate only in Brushed Nickel                            |
|        | SP1862GOLD | Guild Square back plate only in Gold                                      |
|        | SP1862CHR  | Guild Square back plate only in Chrome                                    |
| 9      | SP1863BNKL | Guild Metal block for shower valve in Brushed Nickel                      |
|        | SP1863GOLD | Guild Metal block for shower valve in Gold                                |
|        | SP1863CHR  | Guild Metal block for shower valve in Chrome                              |
| 10     | SP1869BNKL | Guild shower head in Brushed Nickel                                       |
|        | SP1869GOLD | Guild shower head in Gold   |
|        | SP1869CHR  | Guild shower head in Chrome   |